

FIBER TUBE SCORER

Operating Instructions

Warning! This tool should not be used on live electrical circuits. It is not protected against electrical shock! Always use OSHA/ANSI or other industry approved eye protection when using tools. This tool is not to be used for purposes other than intended. Read carefully and understand instructions before using this tool.

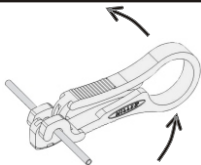

The FTS can score tubes of diameter sizes **1.6mm - 6.0mm** without need for any adjustments.

1. Depress the two legs at the grip pads enough so the U-shaped ends bypass and form the tube scoring opening.
2. Insert the tube.
3. Relax the grip on the legs to close the tool and engage the scoring blade.
4. While continuing to hold the tube, slowly rotate the FTS in a forward direction, for approximately 2-4 revolutions.
NOTE: Depending on the tube size or material, fewer or more revolutions may be needed to fully score the tube.
5. Depress the tool legs once again to remove the tube.
6. Firmly grasping the tube at either side of the score, gently flex the tube to "break" it at the score.
7. Remove or separate the tube sections to access the fibers.

FTS Fiber Tube Scorer - Part No. 80980



80980

WARRANTY: RIPLEY warrants its products against defective materials and workmanship for a period of one year from date of shipment from the RIPLEY factory provided the product is utilized in accordance with instructions and specified ratings.

 **RIPLEY®**

 **MILLER®**

80983 rev.2 12-01-12 ff

46 Nooks Hill Road, Cromwell, CT 06416 USA ~ Ph:800-528-8665 ~ Int'l: (01) 860-635-2200
Fax: (01) 860-635-3631 ~ E-mail: info@ripley-tools.com ~ Internet: www.ripley-tools.com